

# Recessed Access Doors

## FOR DRYWALL



### RDW

The RDW door is recessed to receive a panel of drywall to provide a dry wall finish on the door to match the texture of the surrounding drywall. The door frame includes a drywall bead so that drywall cement can be applied to conceal the flange.

**MATERIAL** Frame: 14 ga. steel  
Door: 16 ga. steel, recessed 1"

**HINGE TYPE** Concealed pivoting rod

**LATCH TYPE** Flush to finished surface; Screwdriver operated with stainless steel cam and studs or cylinder lock with automatic dust shutter

**FINISH** Prime coat of rust inhibitive electrostatic powder, painted white

**NOTES** Galvanized steel drywall bead trim

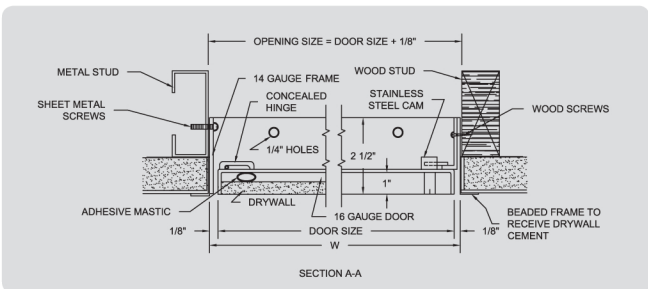

DOOR SIZE (H X W)	WALL / CEILING OPENING	NUMBER OF LATCHES	SHIPPING WEIGHT (LBS)
12" x 12"	12 <sup>1</sup> / <sub>8</sub> " x 12 <sup>1</sup> / <sub>8</sub> "	1	7.4 lbs
18" x 18"	18 <sup>1</sup> / <sub>8</sub> " x 18 <sup>1</sup> / <sub>8</sub> "	2	12.8 lbs
24" x 12"	24 <sup>1</sup> / <sub>8</sub> " x 12 <sup>1</sup> / <sub>8</sub> "	2	12.5 lbs
24" x 24"	24 <sup>1</sup> / <sub>8</sub> " x 24 <sup>1</sup> / <sub>8</sub> "	2	19.4 lbs
36" x 24"	36 <sup>1</sup> / <sub>8</sub> " x 24 <sup>1</sup> / <sub>8</sub> "	2	29 lbs



### RDWPD

The RDWPD provides maximum concealment with minimal installation time and cost. The RDWPD's recessed door contains a factory installed 1/2" drywall to match the texture of the surrounding drywall. The door frame shall include a drywall bead so that drywall cement can be applied to conceal the flange.

**MATERIAL** Frame: 14 ga. steel  
Door: 16 ga. steel, recessed 1/2" with 1/2" factory installed drywall

**HINGE TYPE** Concealed pivoting rod

**LATCH TYPE** Flush to finished surface; Screwdriver operated with stainless steel cam and studs or cylinder lock with automatic dust shutter

**FINISH** Prime coat of rust inhibitive electrostatic powder, painted white

**NOTES** Galvanized steel drywall bead trim

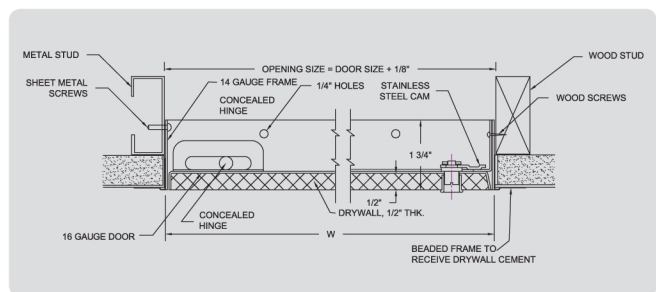

DOOR SIZE (H X W)	WALL / CEILING OPENING	NUMBER OF LATCHES	SHIPPING WEIGHT (LBS)
12" x 12"	12 <sup>1</sup> / <sub>8</sub> " x 12 <sup>1</sup> / <sub>8</sub> "	1	8 lbs
18" x 18"	18 <sup>1</sup> / <sub>8</sub> " x 18 <sup>1</sup> / <sub>8</sub> "	2	15 lbs
24" x 12"	24 <sup>1</sup> / <sub>8</sub> " x 12 <sup>1</sup> / <sub>8</sub> "	2	14 lbs
24" x 24"	24 <sup>1</sup> / <sub>8</sub> " x 24 <sup>1</sup> / <sub>8</sub> "	2	24.5 lbs
36" x 24"	36 <sup>1</sup> / <sub>8</sub> " x 24 <sup>1</sup> / <sub>8</sub> "	2	36.5 lbs